

DR

COPPER TUBE CRIMPING LUGS ACCORDING TO DIN 46235

for Copper conductors

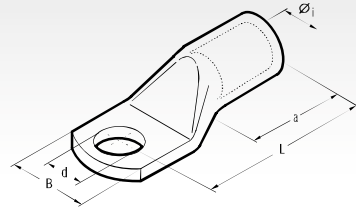

DR series lugs are manufactured from electrolytic Copper tube and designed to obtain high electrical conductivity combined with the mechanical strength required to resist vibration and pull out.

Cembre lugs are annealed and Tin plated for improved surface protection.

The annealing process optimises the structural features of the material allowing easier crimping and greater resistance to mechanical stresses. Dimensions are according to DIN 46235.

The barrel entrance of the lug is chamfered to allow easy conductor insertion, while its length facilitates precise positioning in the crimping die.

Each lug is marked with:

- Cembre logo and part code.
- conductor type and csa (mm²).
- stud Ø (mm).
- crimping die code

Details of the appropriate crimping tools and dies are shown on page 238.

Consult us for special requirements

Conductor Size sqmm	Ø Stud mm	Type	Code	Dimensions mm					Quantity Box/Bag	Mechanical Tools	Hydraulic Tools											
				Øi	d	L	B	a														
6	5	DR6-5	5	3,8	5,3	24,0	8,5	10,0	800/100	HN-D25	B15MD											
	6	DR6-6	5	3,8	6,4	24,0	9,0	10,0	800/100													
	8	DR6-8*	5	3,8	8,4	26,0	13,0	10,0	800/100													
10	5	DR10-5	6	4,5	5,3	27,5	10,0	10,0	800/100						TND 6-70							
	6	DR10-6	6	4,5	6,4	27,0	10,0	10,0	800/100													
	8	DR10-8*	6	4,5	8,4	28,0	13,0	10,0	800/100													
	10	DR10-10*	6	4,5	10,5	28,5	15,0	10,0	800/100													
	5	DR16-5*	8	5,5	5,3	36,0	13,0	20,0	400/100													
16	6	DR16-6	8	5,5	6,4	36,0	13,0	20,0	400/100										TND 10-120	HT45-E B450ND-BV		
	8	DR16-8	8	5,5	8,4	37,0	13,0	20,0	400/100													
	10	DR16-10	8	5,5	10,5	40,0	17,0	20,0	400/100													
	12	DR16-12*	8	5,5	13,0	41,0	19,0	20,0	400/100													
25	6	DR25-6	10	7,0	6,4	39,0	14,6	20,0	400/100	TND 10-120	HT15 RH50 B500 B500ND	HT81-U RHU81	ECW-H3D RHU520									
	8	DR25-8	10	7,0	8,4	39,5	16,0	20,0	400/100													
	10	DR25-10	10	7,0	10,5	40,0	17,0	20,0	200/100													
	12	DR25-12	10	7,0	13,0	40,5	19,0	20,0	200/100													
35	6	DR35-6*	12	8,2	6,4	42,5	17,5	20,0	200/100					TND 10-120	HT15 RH50 B500 B500ND	HT81-U RHU81	ECW-H3D RHU520					
	8	DR35-8	12	8,2	8,4	42,0	17,0	20,0	200/100													
	10	DR35-10	12	8,2	10,5	43,0	19,0	20,0	200/100													
	12	DR35-12	12	8,2	13,0	43,0	21,0	20,0	200/100													
50	16	DR35-16*	12	8,2	17,0	44,0	28,0	20,0	200/100									TND 10-120	HT15 RH50 B500 B500ND	HT81-U RHU81	ECW-H3D RHU520	
	6	DR50-6*	14	10,0	6,4	52,0	20,0	28,0	100/25													
	8	DR50-8	14	10,0	8,4	52,0	20,0	28,0	100/25													
	10	DR50-10	14	10,0	10,5	53,0	22,0	28,0	100/25													
70	12	DR50-12	14	10,0	13,0	53,0	24,0	28,0	100/25	TND 10-120	HT15 RH50 B500 B500ND	HT81-U RHU81	ECW-H3D RHU520									
	16	DR50-16	14	10,0	17,0	57,0	28,0	28,0	100/25													
	8	DR70-8	16	11,5	8,4	56,0	24,0	28,0	50/25													
	10	DR70-10	16	11,5	10,5	56,0	24,0	28,0	50/25													
95	12	DR70-12	16	11,5	13,0	56,0	24,0	28,0	50/25					TND 10-120	HT15 RH50 B500 B500ND	HT81-U RHU81	ECW-H3D RHU520					
	16	DR70-16	16	11,5	17,0	60,0	30,0	28,0	50/25													
	20	DR70-20*	16	11,5	21,0	84,5	30,0	28,0	50/25													
	8	DR95-8*	18	13,5	8,4	65,0	28,0	35,0	50/25													
120	10	DR95-10	18	13,5	10,5	66,0	28,0	35,0	50/25									TND 10-120	HT15 RH50 B500 B500ND	HT81-U RHU81	ECW-H3D RHU520	
	12	DR95-12	18	13,5	13,0	66,0	28,0	35,0	50/25													
	16	DR95-16	18	13,5	17,0	65,5	32,0	35,0	50/25													
	20	DR95-20*	18	13,5	21,0	71,0	33,0	35,0	50/25													
150	8	DR120-8*	20	15,5	8,4	70,0	31,0	35,0	50/25	TND 10-120	HT15 RH50 B500 B500ND	HT81-U RHU81	ECW-H3D RHU520									
	10	DR120-10	20	15,5	10,5	70,0	32,0	35,0	50/25													
	12	DR120-12	20	15,5	13,0	70,5	32,0	35,0	50/25													
	16	DR120-16	20	15,5	17,0	70,0	32,0	35,0	50/25													
185	20	DR120-20	20	15,5	21,0	72,0	36,0	35,0	50/25					TND 10-120	HT15 RH50 B500 B500ND	HT81-U RHU81	ECW-H3D RHU520					
	10	DR150-10	22	17,0	10,5	79,0	34,0	35,0	50/25													
	12	DR150-12	22	17,0	13,0	78,5	34,0	35,0	40/20													
	16	DR150-16	22	17,0	17,0	78,0	34,0	35,0	40/20													
240	20	DR150-20	22	17,0	21,0	78,0	40,0	35,0	50/25									TND 10-120	HT15 RH50 B500 B500ND	HT81-U RHU81	ECW-H3D RHU520	
	10	DR185-10	25	19,0	10,5	83,0	37,0	40,0	25/25													
	12	DR185-12	25	19,0	13,0	82,5	37,0	40,0	25/25													
	16	DR185-16	25	19,0	17,0	82,0	37,0	40,0	25/25													
240	20	DR185-20	25	19,0	21,0	83,0	40,0	40,0	25/25	TND 10-120	HT15 RH50 B500 B500ND	HT81-U RHU81	ECW-H3D RHU520									
	10	DR240-10*	28	21,5	10,5	92,0	42,0	40,0	20/10													
	12	DR240-12	28	21,5	13,0	92,0	42,5	40,0	20/10													
	16	DR240-16	28	21,5	17,0	92,0	42,5	40,0	20/10													
240	20	DR240-20	28	21,5	21,0	92,0	45,0	40,0	20/10					TND 10-120	HT15 RH50 B500 B500ND	HT81-U RHU81	ECW-H3D RHU520					

COPPER TUBE CRIMPING LUGS ACCORDING TO DIN 46235

for Copper conductors

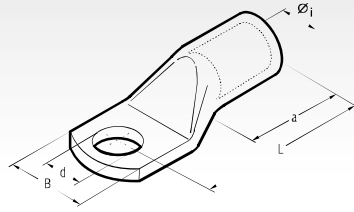

Conductor Size sqmm	Ø Stud mm	Type	Code	Dimensions mm					Quantity Box/Bag	Hydraulic Tools		
				Øi	d	L	B	a				
300	12	DR300-12*	32	24,5	13,0	104,0	47,0	50,0	10/5	RH50 B500 B500ND	HT120 and tools and heads with 130 kN crimping force	ECW-HBD RHUS20
	16	DR300-16	32	24,5	17,0	100,0	48,0	50,0	10/5			
	20	DR300-20	32	24,5	21,0	100,0	47,0	50,0	10/5			
400	12	DR400-12*	38	27,5	13,0	117,0	55,0	70,0	5/5			
	16	DR400-16	38	27,5	17,0	117,0	55,0	70,0	5/5			
	20	DR400-20	38	27,5	21,0	117,0	55,0	70,0	5/5			
500	12	DR500-12*	42	31,0	13,0	130,0	60,0	70,0	5/5			
	16	DR500-16*	42	31,0	17,0	130,0	60,0	70,0	5/5			
	20	DR500-20	42	31,0	21,0	130,0	60,0	70,0	5/5			
625	20	DR625-20	44	34,5	21,0	135,0	63,0	80,0	5/5			
800	20	DR800-20	52	40,0	21,0	166,0	75,0	100,0	5/5			
1.000	20	DR1000-20	58	44,0	21,0	166,0	85,0	100,0	5/5			



Consult us for special requirements

CRIMPING THROUGH CONNECTORS ACCORDING TO DIN 46267 T.1

for Copper conductors

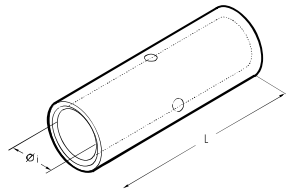

Conductor Size sqmm	Type	Code	Dimensions mm		Quantity Box/Bag	Mechanical Tools		Hydraulic Tools			
			Øi	L							
6	DSV6	5	3,7	30	1.200/100	HN-D25	TND6-70	B15MD	RH50 B500 B500ND	HT81-U RHU81	ECW-HBD RHUS20
10	DSV10	6	4,4	30	1.200/100						
16	DSV16	8	5,5	50	400/100	TND10-120	B450ND-BV	HT45-E	RH50 B500 B500ND	HT81-U RHU81	ECW-HBD RHUS20
25	DSV25	10	7,0	50	200/100						
35	DSV35	12	8,2	50	200/100						
50	DSV50	14	10,0	56	200/50						
70	DSV70	16	11,5	56	100/50						
95	DSV95	18	13,5	70	100/50						
120	DSV120	20	15,5	70	50/25						
150	DSV150	22	17,0	80	50/25						
185	DSV185	25	19,0	85	25/25						
240	DSV240	28	21,5	90	15/15						
300	DSV300	32	24,5	100	10/5						
400	DSV400	38	27,5	150	10/5						
500	DSV500	42	31,0	160	5/5						
625	DSV625	44	34,5	160	5/5						
800	DSV800	52	40,0	200	5/5						
1.000	DSV1000	58	44,0	200	5/5						



DSV series through connectors are manufactured from electrolytic Copper tube, annealed and surface protected by tin plating. Internal and external dimensions match those of DR series lugs. Chamfered ends and a central stop provide easy and correct insertion of the conductor. Details of the appropriate crimping tools and dies are shown on page 238.

Consult us for special requirements