

THROUGH CONNECTORS

for Copper conductors

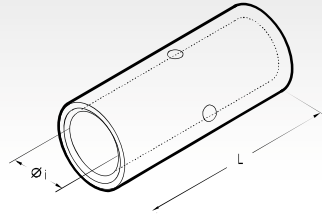

Low Stranded	sqmm Flexible	Type	Dimensions mm		Quantity Box/Bag	Mechanical Tools		Hydraulic Tools	
			øi	L					
0,25÷1,5	0,25÷1,5	L03-M*	1,8	15	6.000/100				
1,5÷2,5	1,5÷2,5	L06-M*	2,4	15	4.000/100				
4÷6	4÷6	L1-M*	3,6	22	2.000/100	HN1			
10	10	L2-M	4,6	25	1.000/100				
16	16	L3-M	5,8	27	1.000/100				
25	25	L5-M	7,0	29	500/100				
35	25÷35	L7-M	8,9	33	400/100				
50	35÷50	L10-M	10,0	37	200/50				
70	50÷70	L14-M	11,3	39	200/50				
95	70÷95	L19-M	13,5	43	100/25				
120	95÷120	L24-M	15,2	47	100/25				
150	120÷150	L30-M	16,7	58	50/25				
185	150÷185	L37-M	19,2	64	50/25				
240	185÷240	L48-M	21,1	75	30/15				
300	240÷300	L60-M	23,7	90	20/10				
400	300÷400	L80-M	27,0	94	15/5				
500	400÷500	L100-M	30,3	98	12/1				
630	500÷630	L120-M*	33,4	105	12/1				
800	600	L160-M*	38,0	112	9/1				
1000	800	L200-M*	44,0	120	6/1				

*See page 127

L-M

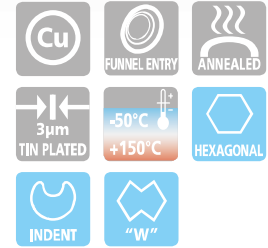

L-M range of connectors are designed for jointing low voltage conductors.

Made of electrolytic Copper tube having the same dimension as A-M series lugs: L-M connectors are annealed and electrolytically Tin plated. They feature an internal taper at both ends to ease the introduction of the conductor and a central stop to ensure correct positioning.

Details of the appropriate crimping tools and dies are shown on pages 230 to 231.

PARALLEL CONNECTORS

for Copper conductors

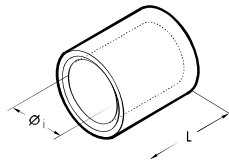

Low Stranded	sqmm Flexible	Type	Dimensions mm		Quantity Box/Bag	Mechanical Tools		Hydraulic Tools	
			øi	L					
0,25÷1,5	0,25÷1,5	L03-P	1,8	6,0	10.000/100				
1,5÷2,5	1,5÷2,5	L06-P	2,4	6,0	5.000/100				
4÷6	4÷6	L1-P	3,6	9,0	3.000/100	HN1			
10	10	L2-P	4,6	10,5	3.000/100				
16	16	L3-P	5,8	11,5	2.000/100				
25	25	L5-P	7,0	13,0	1.500/100				
35	25÷35	L7-P	8,9	14,0	500/100				
50	35÷50	L10-P	10,0	16,0	500/100				
70	50÷70	L14-P	11,3	18,0	500/100				
95	70÷95	L19-P	13,5	19,0	300/50				
120	95÷120	L24-P	15,2	22,0	200/50				
150	120÷150	L30-P	16,7	26,5	100/50				
185	150÷185	L37-P	19,2	26,5	100/50				
240	185÷240	L48-P	21,1	34,0	60/15				
300	240÷300	L60-P	23,7	43,0	50/25				

L-P

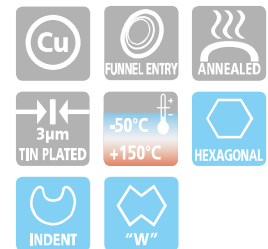

Made of electrolytic Copper tube, having the same dimensions as A-M series lugs, L-P connectors are annealed and electrolytically Tin plated. They feature an internal taper to ease the introduction of the conductor.

Details of the appropriate crimping tools and dies are shown on pages 230 to 231.

♦Not UL approved