

COPPER TUBE CRIMPING LUGS ANGLED 90°

T-L

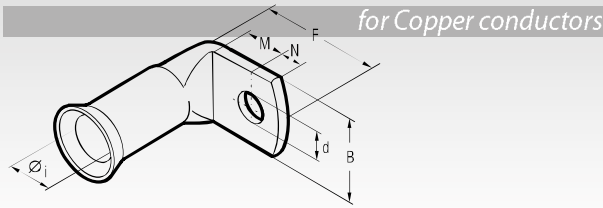

for Copper conductors



Conductor Size sqmm	Ø Stud mm	Type	Dimensions mm						Quantity Box/Bag	Mechanical Tools	Hydraulic Tools				
			Øi	B	M	N	F*	d			HT45-E	B500	B500ND	HT120 and tools and heads with 130 kN crimping force	
4÷6	6	T6-L6	3,3	13,0	9,0	8,0	23,6	6,4	800/100	HNT	B15MD	HT45-E	B500	B500ND	HT120 and tools and heads with 130 kN crimping force
	5	T10-L5	4,2	11,0	6,0	6,0	20,3	5,2	800/100						
10	6	T10-L6	4,2	11,0	8,0	8,0	24,8	6,4	800/100	HNS	B15MD	HT45-E	B500	B500ND	HT120 and tools and heads with 130 kN crimping force
	8	T10-L8	4,2	14,0	11,0	10,0	28,8	8,3	800/100						
16	6	T16-L6	5,3	12,0	9,0	8,0	26,5	6,4	400/100	HN-T25	B15MD	HT45-E	B500	B500ND	HT120 and tools and heads with 130 kN crimping force
	8	T16-L8	5,3	16,0	11,0	10,0	30,5	8,3	400/100						
25	10	T16-L10	5,3	16,0	14,0	12,0	35,5	10,3	400/100	TN70SE	B15MD	HT45-E	B500	B500ND	HT120 and tools and heads with 130 kN crimping force
	6	T25-L6	6,6	13,0	9,0	8,0	28,0	6,4	400/100						
35	8	T25-L8	6,6	16,0	11,0	10,0	32,0	8,3	400/100	TN70SE	B15MD	HT45-E	B500	B500ND	HT120 and tools and heads with 130 kN crimping force
	10	T25-L10	6,6	16,0	14,0	12,0	37,0	10,3	400/100						
50	6	T35-L6	7,9	15,0	9,0	8,0	29,5	6,4	400/50	TN20SE	B15MD	HT45-E	B500	B500ND	HT120 and tools and heads with 130 kN crimping force
	8	T35-L8	7,9	17,0	11,0	10,0	33,5	8,3	200/50						
70	10	T35-L10	7,9	17,0	14,0	12,0	38,5	10,3	400/50	TN20SE	B15MD	HT45-E	B500	B500ND	HT120 and tools and heads with 130 kN crimping force
	6	T50-L6	9,2	18,0	9,0	8,0	31,5	6,4	100/25						
120	8	T50-L8	9,2	18,0	10,0	10,0	35,5	8,3	200/25	TN20SE	B15MD	HT45-E	B500	B500ND	HT120 and tools and heads with 130 kN crimping force
	10	T50-L10	9,2	18,0	14,0	12,0	40,5	10,3	100/25						
150	10	T70-L8	11,0	21,0	11,0	10,0	38,5	8,3	100/25	TN20SE	B15MD	HT45-E	B500	B500ND	HT120 and tools and heads with 130 kN crimping force
	12	T70-L12	11,0	21,0	18,0	16,0	51,5	12,8	100/25						
185	8	T95-L8	13,1	23,0	11,0	10,0	41,0	8,3	100/25	TN20SE	B15MD	HT45-E	B500	B500ND	HT120 and tools and heads with 130 kN crimping force
	10	T95-L10	13,1	23,0	14,0	12,0	46,0	10,3	100/25						
240	12	T95-L12	13,1	23,0	18,0	16,0	54,0	12,8	100/25	TN20SE	B15MD	HT45-E	B500	B500ND	HT120 and tools and heads with 130 kN crimping force
	10	T120-L10	14,5	28,0	14,0	12,0	48,0	10,3	50/25						
300	12	T120-L12	14,5	28,0	18,0	16,0	56,0	12,8	50/25	TN20SE	B15MD	HT45-E	B500	B500ND	HT120 and tools and heads with 130 kN crimping force
	10	T150-L10	16,2	30,0	14,0	12,0	50,0	10,3	40/10						
400	12	T150-L12	16,2	30,0	18,0	16,0	58,0	12,8	40/10	TN20SE	B15MD	HT45-E	B500	B500ND	HT120 and tools and heads with 130 kN crimping force
	10	T185-L10	18,0	33,0	14,0	12,0	52,0	10,3	40/10						

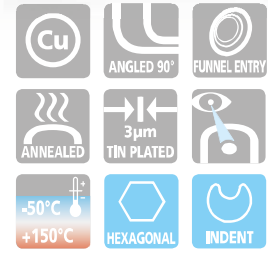

T-L series lugs angled 90° are manufactured from electrolytic Copper tube.
T-L series lugs having the same dimensions and characteristics as T-M series lugs.

F* = indicative dimension

Details of the appropriate crimping tools and dies are shown on pages 240 to 241.

CRIMPING THROUGH CONNECTORS

for Copper conductors

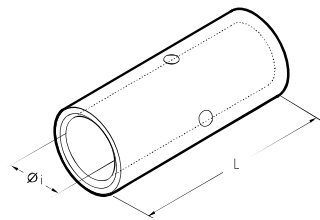

L-T



sqmm		Type	Dimensions mm		Quantity Box/Bag	Mechanical Tools	Hydraulic Tools				
Low Stranded	Flexible		Øi	L			HT45-E	B500	B500ND	HT120 and tools and heads with 130 kN crimping force	
4	4	L4-T	2,7	22	2.000/100	HNT	B15MD	HT45-E	B500	B500ND	HT120 and tools and heads with 130 kN crimping force
4÷6	4÷6	L6-T	3,3	25	1.500/100						
10	10	L10-T	4,2	27	1.000/100	HNS	B15MD	HT45-E	B500	B500ND	HT120 and tools and heads with 130 kN crimping force
16	16	L16-T	5,3	31	500/100						
25	25	L25-T	6,6	35	500/100	HN-A25	B15MD	HT45-E	B500	B500ND	HT120 and tools and heads with 130 kN crimping force
35	25	L35-T	7,9	37	250/50						
50	35	L50-T	9,2	45	250/50	TN70SE	B15MD	HT45-E	B500	B500ND	HT120 and tools and heads with 130 kN crimping force
70	50	L70-T	11,0	50	200/50						
95	70	L95-T	13,1	56	100/25	TN20SE	B15MD	HT45-E	B500	B500ND	HT120 and tools and heads with 130 kN crimping force
120	95	L120-T	14,5	60	100/25						
150	120	L150-T	16,2	66	50/25	TN20SE	B15MD	HT45-E	B500	B500ND	HT120 and tools and heads with 130 kN crimping force
185	150	L185-T	18,0	75	50/25						
240	185	L240-T	20,6	80	30/15	TN20SE	B15MD	HT45-E	B500	B500ND	HT120 and tools and heads with 130 kN crimping force
300	240	L300-T	23,1	90	20/10						
400	300	L400-T	26,1	100	20/5	TN20SE	B15MD	HT45-E	B500	B500ND	HT120 and tools and heads with 130 kN crimping force

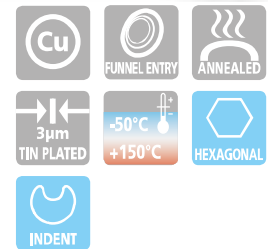

Made of electrolytic Copper tube, having the same dimensions as T-M series lugs, L-T connectors are annealed and electrolytically Tin plated. They feature an internal taper to ease the introduction of the conductor. Details of the appropriate crimping tools and dies are shown on pages 240 to 241.