

TCP

INTERNAL PLUGS FOR CABLE GLANDS

Polyamide PA6.6



PA 6.6



-20°C
+90°C

Material: POLYAMIDE PA6.6
self-extinguishing class V2 (UL 94)
Temperature range:
-20°C to +90°C (continuous)
Colour: RAL 9005 black

Application:
Blanking the cable entry of cable glands and maintaining IP 68.

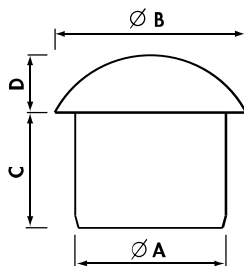

For cable glands type:

MAXIblock[®]
MAXIbrass[®]
MAXIinox

Plugs

Type	Suitable for		Ø A (mm)	Ø B (mm)	C (mm)	D (mm)	Quantity Box/Bag
	MAXIblock [®]	MAXIbrass [®] MAXIinox					
TCP5	M12R + Pg7R	M12R	4,5	8,5	10,8	4,5	3.000/100
TCP10	Pg9R	Pg9R	6,0	12,0	12,0	4,5	2.000/100
TCP12	M12 + Pg7	M12 + Pg7	6,8	12,0	12,0	4,5	1.000/100
	M16R + Pg11R	M16R + Pg11R					
TCP15	Pg9	Pg9	8,0	11,0	11,5	5,0	1.500/100
TCP18	M16 + Pg11	M16 + Pg11	9,5	12,5	13,0	5,0	800/100
	M20R	M20R					
TCP20	Pg13,5 + Pg13,5R	Pg13 + Pg13,5R	10,0	15,0	14,0	6,0	800/100
	Pg16R	Pg16R					
TCP25	M20 + Pg16	M20 + Pg16	12,5	17,0	15,0	8,0	400/100
TCP30	M25R + M32R	M25R + M32R	12,5	22,5	18,0	9,0	300/100
	Pg21R	Pg21R					
TCP35	M25 + Pg21	M25 + Pg21	16,0	19,5	18,0	8,0	300/100
TCP40	M32	M32	19,0	22,5	19,0	9,0	150/50
TCP45	M40R + Pg29 + Pg36R	M40R + Pg29	22,0	30,0	20,0	10,0	100/50
TCP50	M40 + M50R + Pg42R	M40 + M50R	27,5	38,0	25,0	12,0	50/25
TCP55	Pg36	Pg36	31,5	36,5	23,5	12,0	50/25
TCP60	M50	M50	34,5	40,0	23,5	12,0	50/25
TCP65	M63R + Pg42 + Pg48R	M63R + Pg42	37,5	48,0	26,5	12,0	30/15
TCP70	M63 + Pg48	M63 + Pg48	43,0	48,0	26,5	12,0	30/15

R: reduced cable entry