

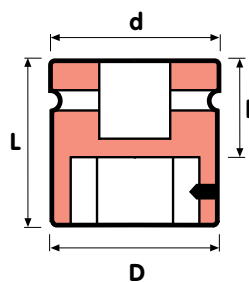



Hållare

Holders

Halter





		Part No	D mm	d mm	L mm	l mm	 kg
3/8	1/4	H1-1/4	15	19	34	20,5	0,05
3/8	7/16	H1-7/16	22,6	22,6	34	22	0,08
1/2	7/16	H4-7/16	22,6	25	38	26	0,10
1/2	7/8	H4-7/8	38	30	50	30	0,29
5/8	7/8	H8-7/8	38	35	55	35	0,33
3/4	7/8	H2-7/8	44	44	55	35	0,46
1	7/8	H9-7/8	48	54	60	40	0,70
1	1 1/4	H9-1 1/4	63	54	75	45	1,20
1 1/2	1 1/4	H5-1 1/4	68	84	88	58	2,33
1 1/2	1 3/4	H5-1 3/4	84	84	110	70	3,24

Insatsmejslar

Insert bits

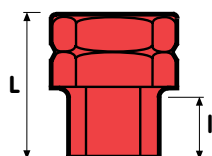
Einsatzklingen

7/16" 

	Part No	L mm	l mm	 kg
5	7/16-5	28	6	0,02
6	7/16-6	28	7	0,02
8	7/16-8	28	8	0,02
10	7/16-10	28	12	0,02
12	7/16-12	28	13	0,03
14	7/16-14	28	13	0,03
17	7/16-17	28	13	0,04
1/4	7/16-1/4	28	7	0,02
5/16	7/16-5/16	28	8	0,02
3/8	7/16-3/8	28	12	0,02
7/16	7/16-7/16	28	12	0,02
1/2	7/16-1/2	28	13	0,03
9/16	7/16-9/16	28	13	0,03

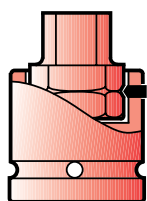

Insatsmejslarna låses med en spetsig skruv mot ett v-format spår i insatsmejselns hörn. Vid behov kan skruven säkras ytterligare med gänglåsningsmedel.

The insert bit is secured by means of a pointed screw against a v-shaped groove in the corners of the insert bit. If necessary the screw can be further secured by a tread-locking material.

Die Einsatzklinge wird durch eine Spitzschraube in einer V-förmigen Nut im Eckbereich der Klinge gesichert. Wenn erforderlich, kann die Schraube mit einem Klebstoff weiter gesichert werden.